

IQOS  
ILUMA

P R I M E

User Guide

## IQOS ILUMA PRIME™ Pocket Charger

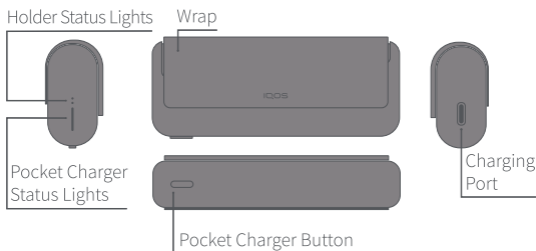

## IQOS ILUMA™ Holder

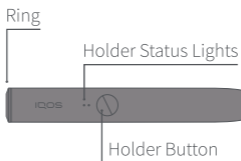

IQOS ILUMA™ is compatible only with SMARTCORE STICKS™

## Charging

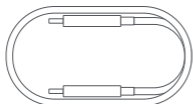

Charging Cable

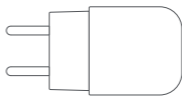

Power Adaptor



For the **full user guide**,  
**Customer Care** and  
**Extended support**  
**services for IQOS users**,  
visit

[www.iqos.com/myiqos](http://www.iqos.com/myiqos)

## FEATURES AND SETTINGS

Can be turned on or off  
with the IQOS app\*.

Please register by scanning  
QR code or log in on  
[www.iqos.com/iluma](http://www.iqos.com/iluma)  
and follow the instructions.

\* IQOS app may not be available in  
your country.

## Getting Started

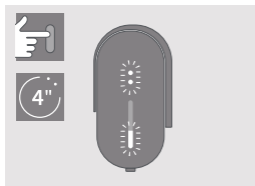

### TURN ON

Press and hold Pocket Charger Button for 4 seconds, then release; Pocket Charger Status Lights and Holder Status Lights will turn on slowly.

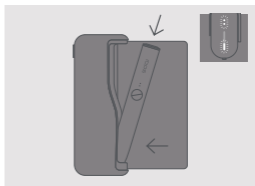

### CHARGE HOLDER

Insert Holder into the Pocket Charger, then close Wrap to charge.

Holder Status Light will show Holder battery level.

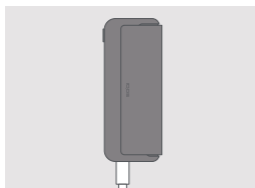

### CHARGE POCKET CHARGER

Before first use, fully charge your device with Power Adaptor and Charging Cable.  
(approx. 135 min)

# How to use your IQOS ILUMA PRIME™

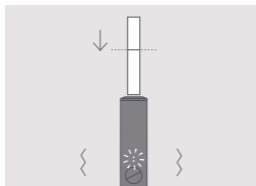

## 1. INSERT SMARTCORE STICK™

Insert the SMARTCORE STICK™ to the line on filter until Holder vibrates and Light(s) pulse(s).

Heating starts automatically, or by pressing Button for 1 second.

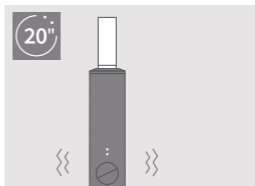

## 2. BEGIN USE

Start using once Holder vibrates and Lights stay fixed.



## 3. NEARLY COMPLETE

To signal the last 30 seconds or last 2 puffs, Holder will vibrate with Light(s) pulsing white.



## 4. REMOVE SMARTCORE STICK™

Remove used SMARTCORE STICK™ and dispose as per Safety Warnings and Instructions.

## How to use your IQOS ILUMA PRIME™

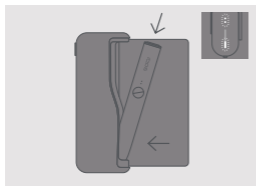

### 5. RECHARGE HOLDER

Insert the Holder in the Charger for recharging.

## Quick Tips

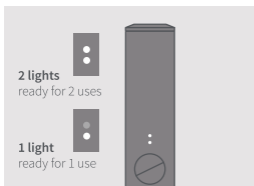

### CHECK HOLDER STATUS

Tilt Holder towards you or short press Button, Holder Lights indicate Holder battery level.

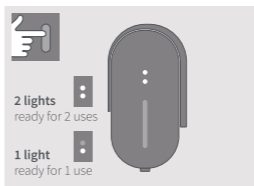

### CHECK HOLDER STATUS ON THE POCKET CHARGER

Short press Pocket Charger Button. Holder Status Light will turn on.

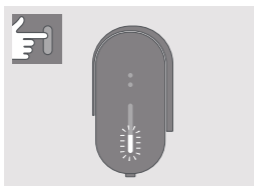

### CHECK POCKET CHARGER STATUS

Short press Pocket Charger Button. Pocket Charger Status Lights will turn on to indicate battery level.



### AUTOSTOP

During use, the experience will stop if the SMARTCORE STICK™ is moved, or removed from the Holder.

## Quick Tips

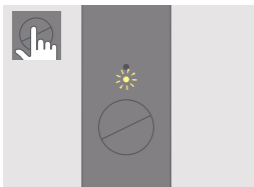

### LIGHT BLINKS YELLOW

Battery depleted, need to charge.

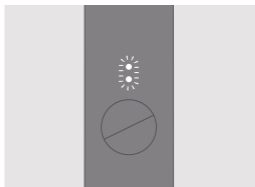

### LIGHTS BLINK WHITE TWICE

IQOS ILUMA PRIME™ is outside operating temperature range (0°C~40°C).

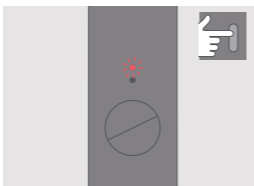

### LIGHT BLINKS RED

Reset Pocket Charger.  
If red light blinking persists,  
contact Customer Care.

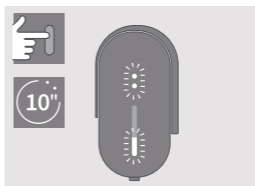

### TO RESET

Place Holder in Pocket  
Charger and press Button  
for 10 seconds then release.  
All Status Lights will turn OFF,  
and turn ON, to confirm  
a RESET.